

CONDITIONS OF USE OF THIS DRAWING:  
A. This drawing shall be read in conjunction with all relevant civil, structural, mechanical and electrical drawings together with the specifications and schedules.  
B. All dimensions are in millimetres and metric units. Do not scale off this drawing. Use figure dimensions only.  
C. All dimensions are to face of work or back or start/finish unless stated otherwise.  
D. Contractor must verify all dimensions on the ground before any construction work, or proceeding any other drawings.  
E. All dimensions are to be confirmed with the manufacturer's data or by testing by the manufacturer.  
F. All dimensions are to be confirmed with the manufacturer's data or by testing by the manufacturer.  
G. All dimensions are to be confirmed with the manufacturer's data or by testing by the manufacturer.  
H. All dimensions are to be confirmed with the manufacturer's data or by testing by the manufacturer.  
I. All dimensions are to be confirmed with the manufacturer's data or by testing by the manufacturer.  
J. All dimensions are to be confirmed with the manufacturer's data or by testing by the manufacturer.  
K. All dimensions are to be confirmed with the manufacturer's data or by testing by the manufacturer.  
L. All dimensions are to be confirmed with the manufacturer's data or by testing by the manufacturer.  
M. All dimensions are to be confirmed with the manufacturer's data or by testing by the manufacturer.  
N. All dimensions are to be confirmed with the manufacturer's data or by testing by the manufacturer.  
O. All dimensions are to be confirmed with the manufacturer's data or by testing by the manufacturer.  
P. All dimensions are to be confirmed with the manufacturer's data or by testing by the manufacturer.  
Q. All dimensions are to be confirmed with the manufacturer's data or by testing by the manufacturer.  
R. All dimensions are to be confirmed with the manufacturer's data or by testing by the manufacturer.  
S. All dimensions are to be confirmed with the manufacturer's data or by testing by the manufacturer.  
T. All dimensions are to be confirmed with the manufacturer's data or by testing by the manufacturer.  
U. All dimensions are to be confirmed with the manufacturer's data or by testing by the manufacturer.  
V. All dimensions are to be confirmed with the manufacturer's data or by testing by the manufacturer.  
W. All dimensions are to be confirmed with the manufacturer's data or by testing by the manufacturer.  
X. All dimensions are to be confirmed with the manufacturer's data or by testing by the manufacturer.  
Y. All dimensions are to be confirmed with the manufacturer's data or by testing by the manufacturer.  
Z. All dimensions are to be confirmed with the manufacturer's data or by testing by the manufacturer.

Total Site Area		
Area (sq.m)	Area (ha)	Area (Acres)
37959.6 m <sup>2</sup>	3.80 hectare	9.38 acres

Site Drawings Legend	
<span style="color: red;">—</span>	Site Boundary
<span style="color: blue;">—</span>	Total Landholding
<span style="color: green;">—</span>	Contour (1.0m Interval)
<span style="color: brown;">—</span>	Contour (0.5m Interval)
<span style="color: blue;">---</span>	Existing Storm Drain
<span style="color: red;">---</span>	Existing Foul Drainage
<span style="color: blue;">---</span>	Water Supply
<span style="color: yellow;">---</span>	Easement

Easement\*  
3m Offset from the edge of foul sewer in accordance with:  
-3.5.9 of Code of Practice For Water Infrastructure (July 2020 Rev2)  
Document IW-CDS-5020-03  
-Code of Practice for Wastewater Infrastructure  
July 2020 (Rev2) Document IW-CDS-5030-03

Note  
Watermain to be re-routed



2: BHB2 & BHB1 - No. 42 & 44  
Scale - 1 : 200

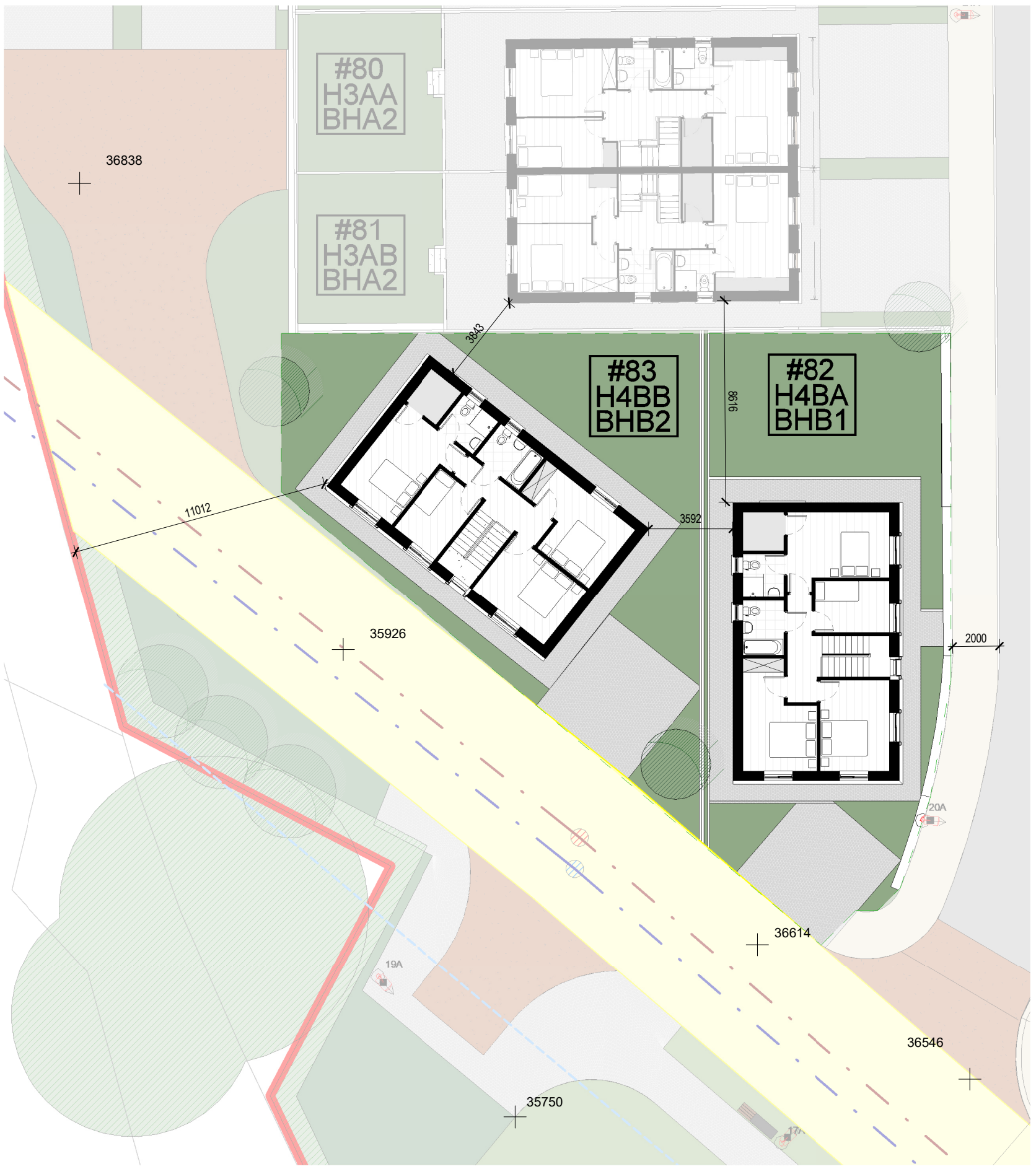

3: BHB2 & BHB1 - No. 83 & 82  
Scale - 1 : 200

1: Proposed Site Layout Plan  
Scale - 1 : 500

